



LUMI

**The All-New Princess Y80**



**Available for charter in the summer season 2024 in Mallorca**  
**8 Guests | 4 Cabins**  
**from EUR 63,000 p/week**

Loa 25.50 m (83' 8") Beam 6.07 m (19' 11") Draft 2 m ( 8") Built 2023  
Builder Princess Guests 8 Cabins 4 Crew 3 Speed 24 knots



Bow seating area



Flybridge dining



Bow seating area



Cockpit dining area



Teak side decks



Hydraulic swim platform





Main Saloon



Main Saloon



Pilot House



Dining area





Master Stateroom



VIP guest cabin



Guest cabin



En-Suite



### **EQUIPMENT**

Engines:	2 x MAN 1900hp
Generators:	2 x 27kw Kohler
Generators consumption:	500ltrs/day
Cruising Speed:	12 knots
Fuel Consumption:	380 Litres/Hr

### **ACCOMMODATION**

Number of Guests:	8
Number of Cabins:	4
Cabin Configuration:	2 Double, 2 Twin
Bed Configuration:	2 Double, 4 Single

### **WATERSPORTS**

Tender + Toys:  
Williams 435  
2 x Seabobs  
2 x Stand up paddle board  
Water skis equipment  
Snorkeling equipments  
Donuts

### **KEY FEATURES**

The all-new Y80 features elegant refined proportions and details with a clean, timeless aesthetic and exceptional standard

Meticulously detailed surroundings finished with the finest materials

Generous beam, the Y80 provides significant volume for an 80-foot motor yacht

The foredeck has been designed to offer a secluded escape to while-away an afternoon or an elegant entertaining space to sip cocktails with guests

The main deck offers an uninterrupted flow through from the cockpit to the helm featuring vast windows along the saloon

Below deck, four en-suite cabins sleep eight supported by crew quarters

Flybridge offers relaxed seating and dining areas combined with a fully equipped wetbar

Floating island – Direct access to sea

Zero speed stabilizers

Low fuel consumption

4 luxurious en-suite cabins

Bright, contemporary yet homey interior

Professional crew led by the very experienced in Balearics waters captain Paul

  
LUMI

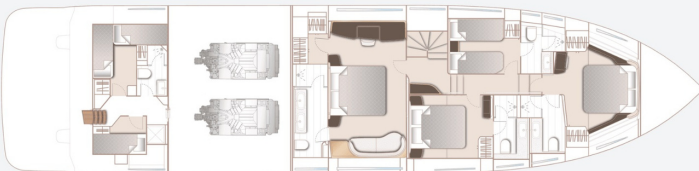

#### PRINCIPAL DIMENSIONS

<b>Length overall (incl. pulpit)</b>	83ft 8in (25.50m)
<b>Length overall (excl. pulpit)</b>	82ft 5in (25.12m)
<b>Beam</b>	19ft 11in (6.07m)
<b>Displacement (half load)</b>	66,026kg (145,562lbs)*
<b>Fuel capacity</b>	1,540 gal/1,849 US gal/7,000l
<b>Water capacity (excl. calorifier)</b>	308 gal/370 US gal/1,400l

#### ENGINES

<b>Twin MAN V12 (2 x 1,800hp)</b>	Speed range: 30-32 knots†
-----------------------------------	------------------------------